

PROJECT INFORMATION:

Project Management: EXEC BTS

Floor Dimensions: 200 m²

Projected Capacity: 23 employees

Location: Ed. Sun Tower - São José dos Campos

Implementation Timing: 25 days, starting August 13th 2010. Key hand over Sept. 19

Main Suppliers:

Architect : Shussel + Quezada

Main Contractor:

Air Conditioning Project : CIVAC

Air Conditioning Supplier: BPM

Lighting System : Philips

Floor Carpeting :

Office Furniture : Intelligent Table / Flexform

Partitioning :

Blinds : Luxaflex

Sprinkler:

Fire Detection&Alarm:

Office Area Requirements :

- ✓ Back Office for 27 workstations
- ✓ Three Meeting Rooms:
 - ✓ one 12 seats
 - ✓ two 03 seats
- ✓ Reception area,
- ✓ IT Room
- ✓ Cyber Coffee area

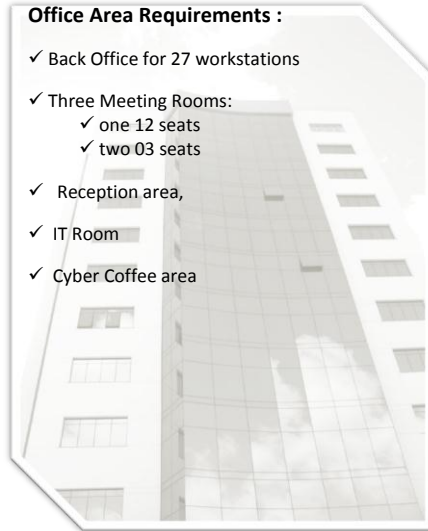

SNAP SHOTS DURING FITTING IN:



LAYOUT:

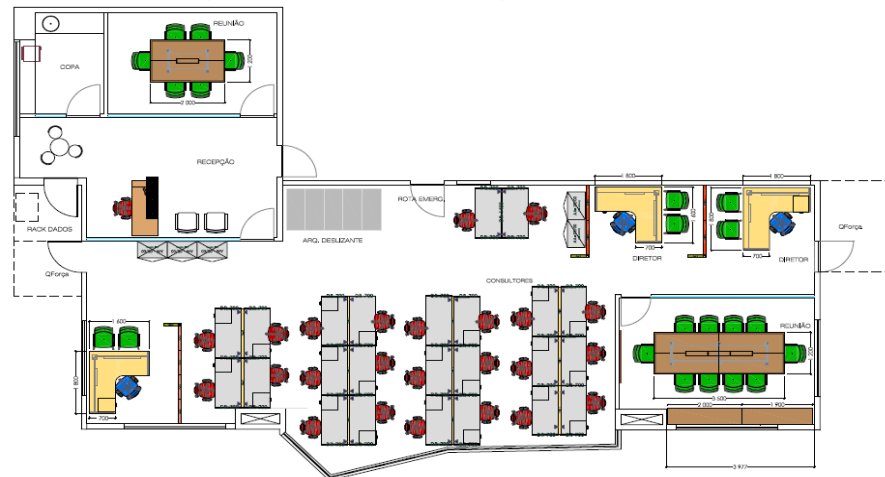

SPACE READY:

Meeting Room



Workstations



Cyber Caffee



Overall view



Manager's Desk

